

CLIFF

Panel & PCB Mounting Fuseholders

The **CLIFF**[®] range of Fuseholders comprises several models for panel, vertical or horizontal PCB mounting and for either 5 x 20mm or 6 x 32mm fuses. Most models are UL / CSA and EU approved and are rated at 10A / 250VAC. FHB01 is rated at 15A / 250V.



FHB12 Snap-In Panel Mounting Fuseholder. Screw-driver operation. Rated 10A / 250VAC. Suitable for 5 X 20 mm fuses. UL, SEMKO, CSA & VDE approved.

FHB12 (FE69185)

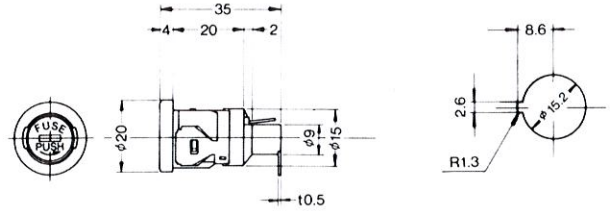

FHS07 Snap-In Panel Mounting Fuseholder. Screw-driver operation. Rated 10A / 250VAC. Suitable for 1/4" fuses. UL & CSA approved.

FHS07 (FE6912)

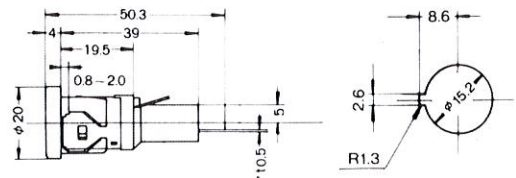

F20B Professional Quality Low Profile Panel Mounting Fuseholder. Rated 10A / 250VAC. Suitable for 5X20 fuses. UL, SEMKO, TÜV, CSA & VDE approved.

F20B (FE69005)

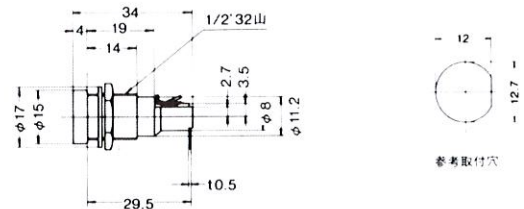

FHB01 Panel Mounting Fuseholder. Screw top. Rated 15A / 250VAC. Suitable for 1/4" fuses. UL & CSA approved.

FHB01 (FE69175)

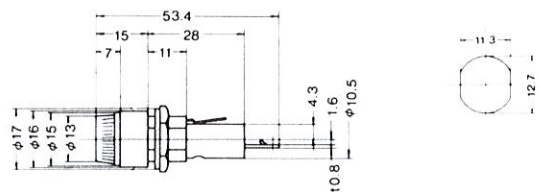

Cliff Electronic Components, Ltd.
 76 Holmethorpe Avenue, Holmethorpe Ind. Est.
 Redhill, Surrey RH1 2PF. England
Tel: +44 (0) 1737 771375
Fax: +44 (0) 1737 766012
Email: sales@cliffuk.co.uk



Visit us online at:

www.cliffuk.co.uk



FHB13H Right Angle PCB Mounting Fuseholder. Bayonet open with screwdriver slot. Rated 10A / 250VAC. UL, CSA & VDE approved.

FHB13H (FE69186)

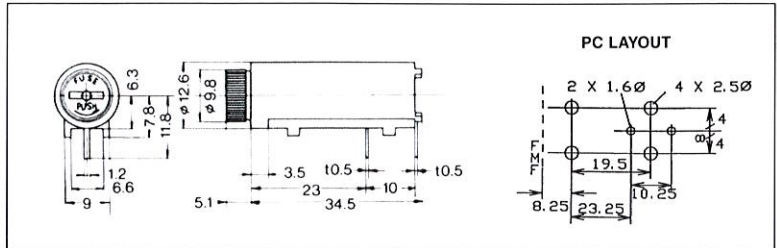

FHB13V Vertical PCB Mounting Fuseholder. Bayonet open with screwdriver slot. Rated 10A / 250 VAC. UL, CSA & VDE approved.

FHB13V (FE69187)

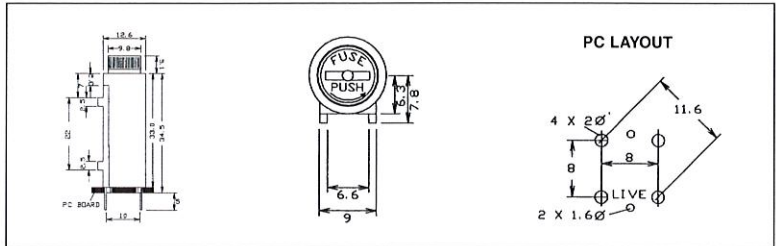

PVC Insulating Cover for Panel Mounting Fuseholders.

PVC COVER (FE69001)

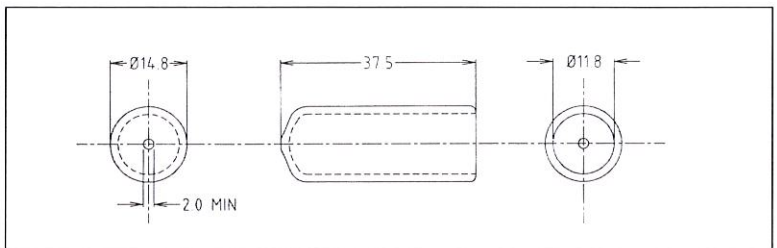

PCB Fuse Clip. Low profile. For 1/4" (6.35mm) fuses.

FCR 205 (SA15)

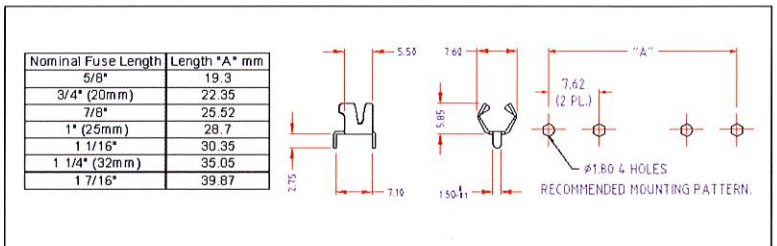

Electrical Specifications:

Rated Current: 10A (FHB01-15A)

Rated Voltage: 250VAC.

Contact Resistance: 2MΩ @ 250V DC or less.

Dielectric Withstand: 1 minute @ 1500VAC.

Insulation Resistance: 100MΩ or more @ 500V DC.

Approvals:

UL File No.: E46754 (Not applicable to PCB Fuse Clip)

CSA File No.: LR30024

VDE Reg. No.: 46506