

ISS.	AMEND	DATE
1	REDRAWN	02/05/2014

NOTES:-

1. MAXIMUM PANEL THICKNESS 4.3mm.
2. SUPPLIED WITH NUT, BEZEL & WASHERS ASSEMBLED.

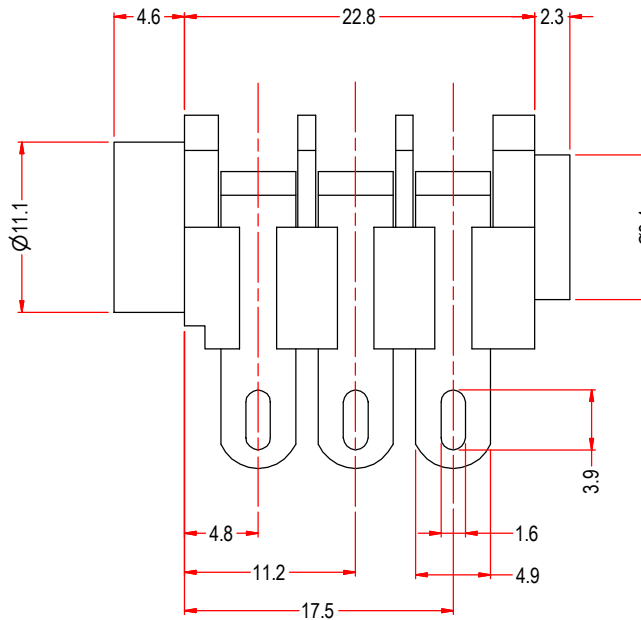
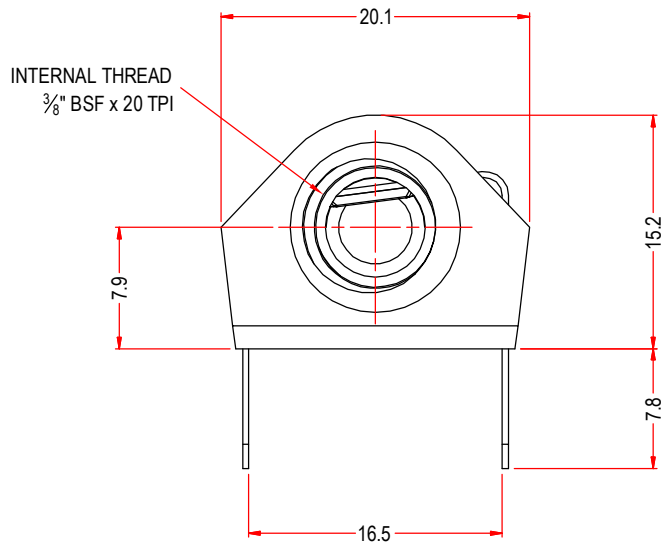
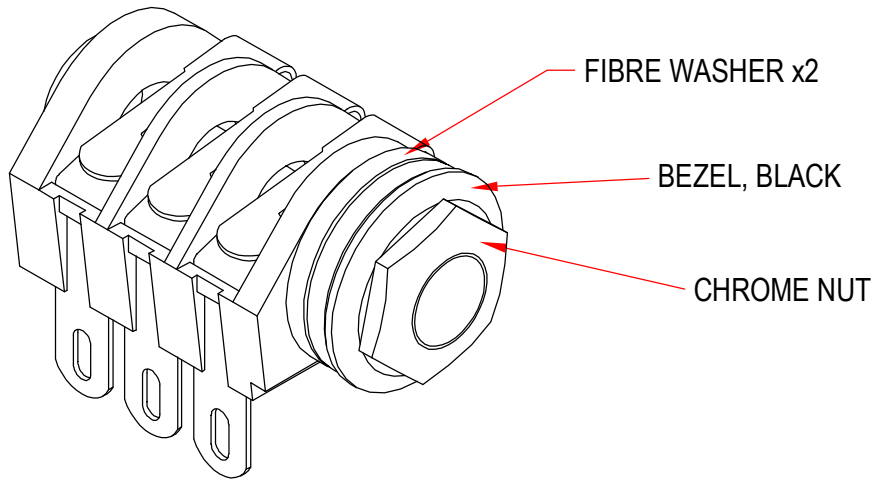

SCHEMATIC

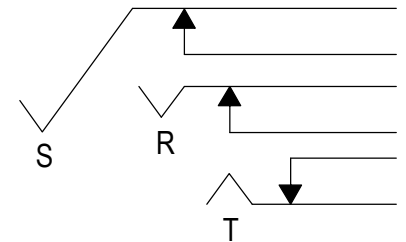

SWITCH CONTACTS OPEN WHEN PLUG IS INSERTED, CLOSE WHEN PLUG IS WITHDRAWN.

RoHS
COMPLIANT

TOLERANCE
 NO DEC. PLACE ±
 1 DEC. PLACE ± 0.20
 2 DEC. PLACE ±
 HOLE Ø ±
 ANGLES ± 1/2°
 UNLESS OTHERWISE STATED

1ST DRAWN : 11/01/1991
 3rd ANGLE PROJECTION:

DO NOT SCALE

Cliff Electronic Components Ltd.

DIMENSIONS IN MILLIMETERS UNLESS OTHERWISE STATED. WORK TO DIMENSIONS. REMOVE ALL BURRS. IF IN DOUBT ASK.

TITLE: JACK SOCKET S4/BBB/ST BLACK

76 Holmethorpe Avenue, Holmethorpe Industrial Estate, Redhill, Surrey, RH1 2PF, England, UK
 Tel: 01737-771375 Fax: 01737-766012 Website: www.cliffuk.co.uk

MATERIAL: NYLON / NiAg / FIBRE / POM / BRASS
 FINISH: AS MOULDED / MICROFINISH

DRWG. No. **CL 1322 A** FORM: A4DRWGH

THE CONTENTS OF THIS DOCUMENT MUST NOT BE COPIED OR DISCLOSED TO A 3rd PARTY WITHOUT WRITTEN PERMISSION OF CLIFF UK. © 1991

DRAWN: NJB APPROVED: DPJ