

ISS.	AMEND	DATE
1	REDRAWN	04/10/90
2	RS ADDED	01/02/91
3	NOTE ADDED	24/05/93
4	PIN SEQ CORR	18/12/95
5	UPDATE+RS REMOVED	06/03/20

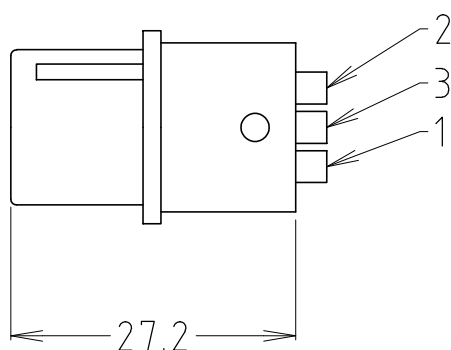
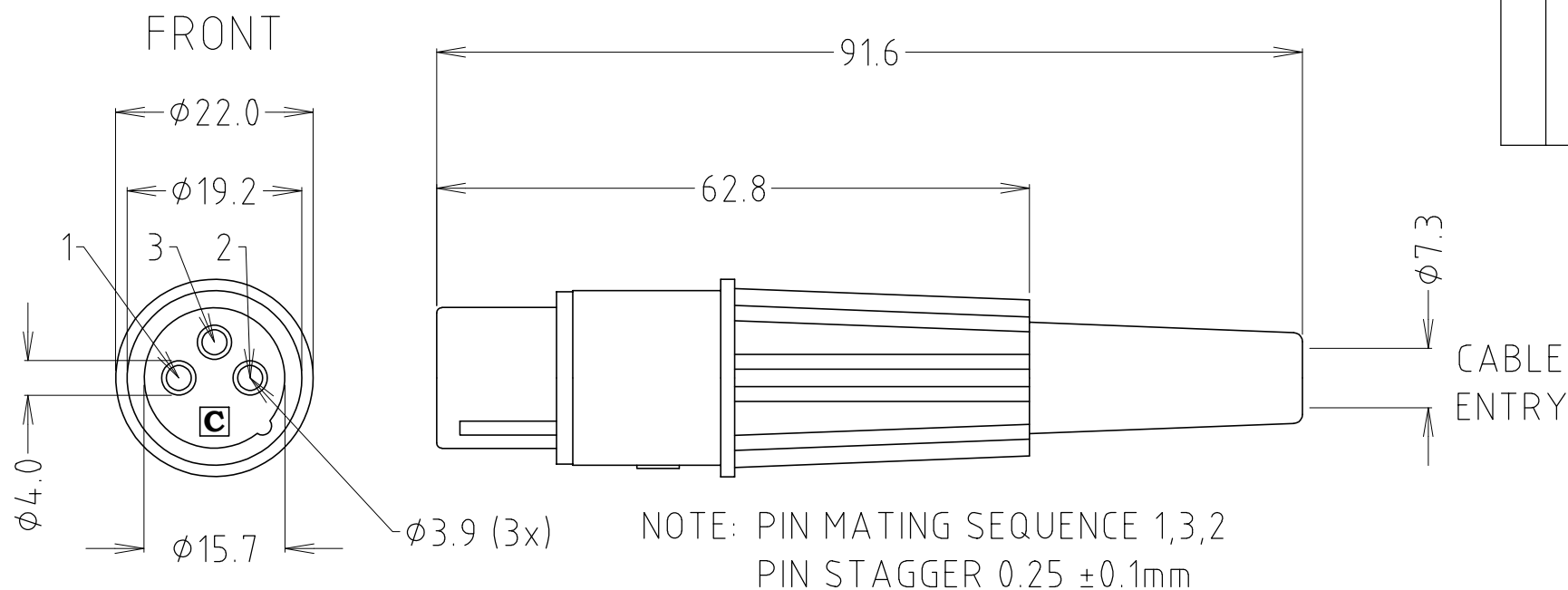

RoHS ✓ COMPLIANT
TOLERANCE
NO DEC. PLACE ±
1 DEC. PLACE ± 0.15
2 DEC. PLACE ±
HOLE Ø ±
ANGLES ±
UNLESS OTHERWISE STATED
DO NOT SCALE

Cliff Electronic Components Ltd.
76 Holmethorpe Avenue, Holmethorpe Industrial Estate,
Redhill, Surrey, RH1 2PF, England, UK
Tel: 01737-771375 Fax: 01737-766012 Website: www.cliffuk.co.uk

THE CONTENTS OF THIS DOCUMENT MUST NOT BE COPIED OR DISCLOSED TO A 3rd PARTY WITHOUT WRITTEN PERMISSION OF CLIFF UK. © 1990

DIMENSIONS IN MILLIMETERS UNLESS OTHERWISE STATED. WORK TO DIMENSIONS. REMOVE ALL BURRS. IF IN DOUBT ASK.

MATERIAL: POLYAMIDE / BRASS

FINISH: BLACK - AS MOULDED / Ag PLATED

DRAWN: C.A.M.J. APPROVED: R.W.T.

3rd ANGLE PROJECTION:

TITLE: XLR PLUG APF (FEMALE)

DRWG. No. CP3003

FORM: A4DRWGH