

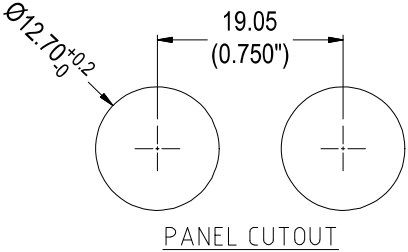

# DUAL TOUCHPROOF TERMINAL TPP4

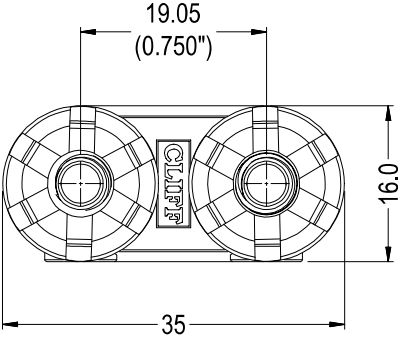

RED

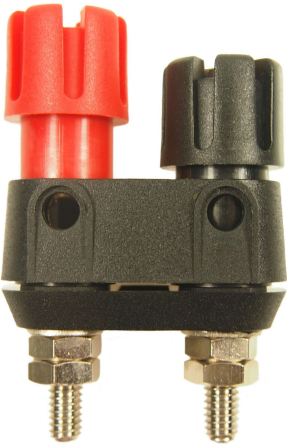
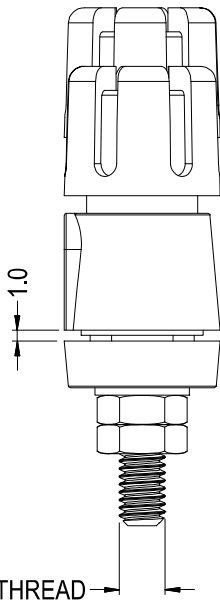
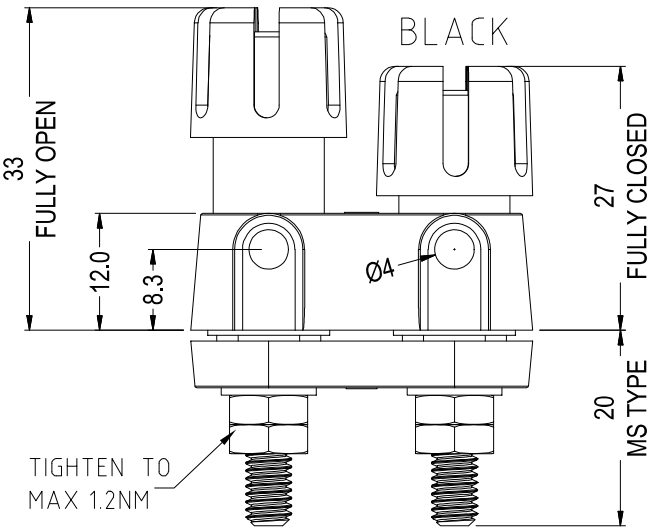
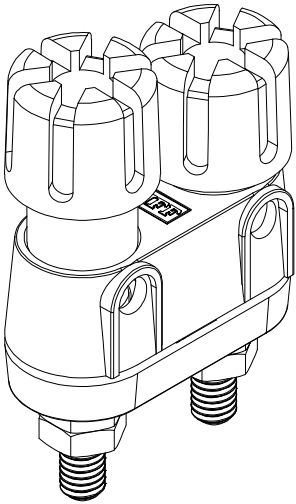

2BA THREAD

Part No. **CL159705** - TPP4 Terminal. Supplied assembled

**Specification**

- Maximum Current: 30A.
- Contact Resistance: <30mΩ
- Temperature Rating: -20°C to +80°C
- Max wire size: 6mm<sup>2</sup>
- Material: Glass filled nylon / PP / Nickel plated.

